



OPTIMISES ROOT ZONE DRAINAGE WITH AUTOPOT WATERING SYSTEMS

REMOVES THE NEED FOR A PEBBLE LAYER IN THE BASE OF YOUR POT

DESIGNED FOR EASY OPTIONAL INTEGRATION WITH AIRDOME



AirBase Square fits AutoPot 8.5L and 15L plastic pots as used in 1Pot modules (pictured) and easy2grow modules



AirBase Round fits AutoPot 25L plastic and 20L fabric pots as used in XL and XL FlexiPot modules



AIRBASE SQUARE



AIRBASE ROUND



 @AUTOPOT_GLOBAL

 @AUTOPOTSYSTEMS



 AUTOPOT.CO.UK

 @AUTOPOTUK



PRODUCED FROM TOUGH ABS PLASTIC - EXTENSIVELY REUSABLE

REMOVABLE CENTRE SECTION ACCOMMODATES AIRDOME

AIRDOME AERATES ROOT ZONE - FOR SUPERCHARGED GROWTH

AIRBASE SQUARE FOR: AutoPot 8.5L & 15L plastic pots

AS USED IN:



AIRBASE ROUND FOR: AutoPot 25L plastic & 20 L fabric pots

AS USED IN:



SETUP GUIDE

Follow directions below for AirBase Square and AirBase Round



1

Prepare your pots with root control as usual. Refer to your system instructions for relevant guidance.

If using AirBase **without** AirDome go to **Step 2**

If using AirBase **with** AirDome go to **Step 3**



2

If using without AirDome

Place AirBase into the base of your pot.

Go to Step 5



3

If using with AirDome

Remove AirBase centrepiece.

Place AirBase over your assembled AirDome

Ensure air pipe is fitted into notch on underside of AirBase.

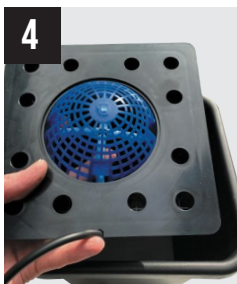

4

If using with AirDome

Lower the AirDome and AirBase into pot. Ensure air pipe is fitted into the notch on the side of the AirBase.

Your air pipe routes up over the pot edge to your air pump.

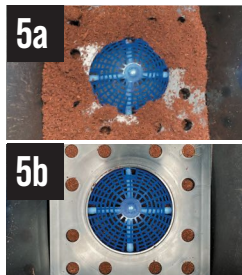

5a

All configurations

Pour a small amount of medium into the pot (5a).



5b

Push the medium down through holes in the Base (5b) - **this is essential for capillary action to occur.**



6

All configurations

Fill pots with medium and pot up plants. Water through pots and allow to drain outside the tray.

Once drained place pots into your module trays.